

Stainless Steel Horizontal Pumps

RAE's GTPH Series horizontal end suction multistage pumps are intended for industrial use to carry clean water and fluids without abrasives.

Reliable, quiet, and compact, these non-self-priming pumps feature a coupling connection between the pump shaft and motor shaft.

Stainless steel construction of all parts in contact with pumped fluid ensures corrosion free operation.

All stainless construction and single phase motors are available as options; consult factory for more information.

Applications:

- Industrial circulation systems
- Wash systems
- Pressure boosters
- Liquid transfer
- Agricultural irrigation

MOTOR

Nominal speed: 3500 rpm at 60 Hz
Standard voltage: 3 phase; 230V/460V
Protection class: IP54
Insulation class: F



MODEL CODE

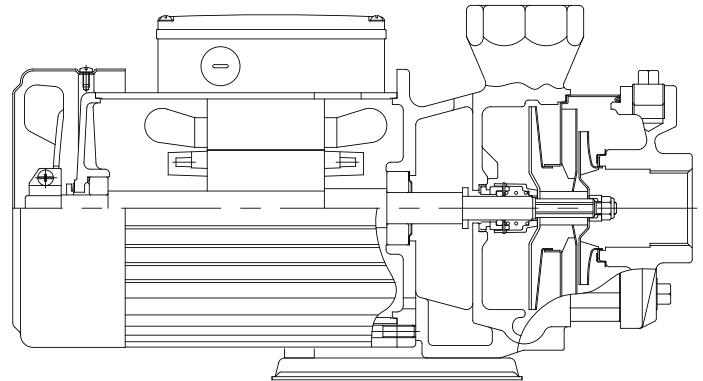

GTPH 8T - 2K

- Number of impellers
- Model (rate of flow)
- Series

OPERATING LIMITS

Ambient temperature: Max 104°F
Liquid temperature range: 32°F to 194°F
Flow: 17 gpm to 44 gpm
Head: 40' to 160'
Operating pressure: Max 142 psi
Inlet pressure: Max 85 psi

PERFORMANCE CURVES

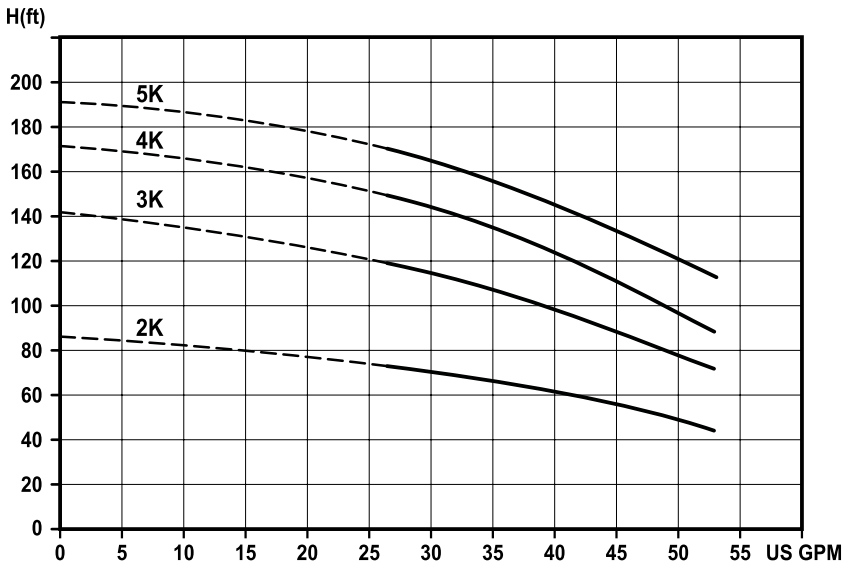

ELECTRICAL DATA

Model	Amps (A)		Power (hp)
	230V	460V	
GTPH8T2K	4.0	2.4	0.75
GTPH8T3K	6.2	3.5	1.5
GTPH8T4K	7.9	4.4	2.0
GTPH8T5K	8.1	4.6	2.0

DIMENSIONS — WEIGHTS

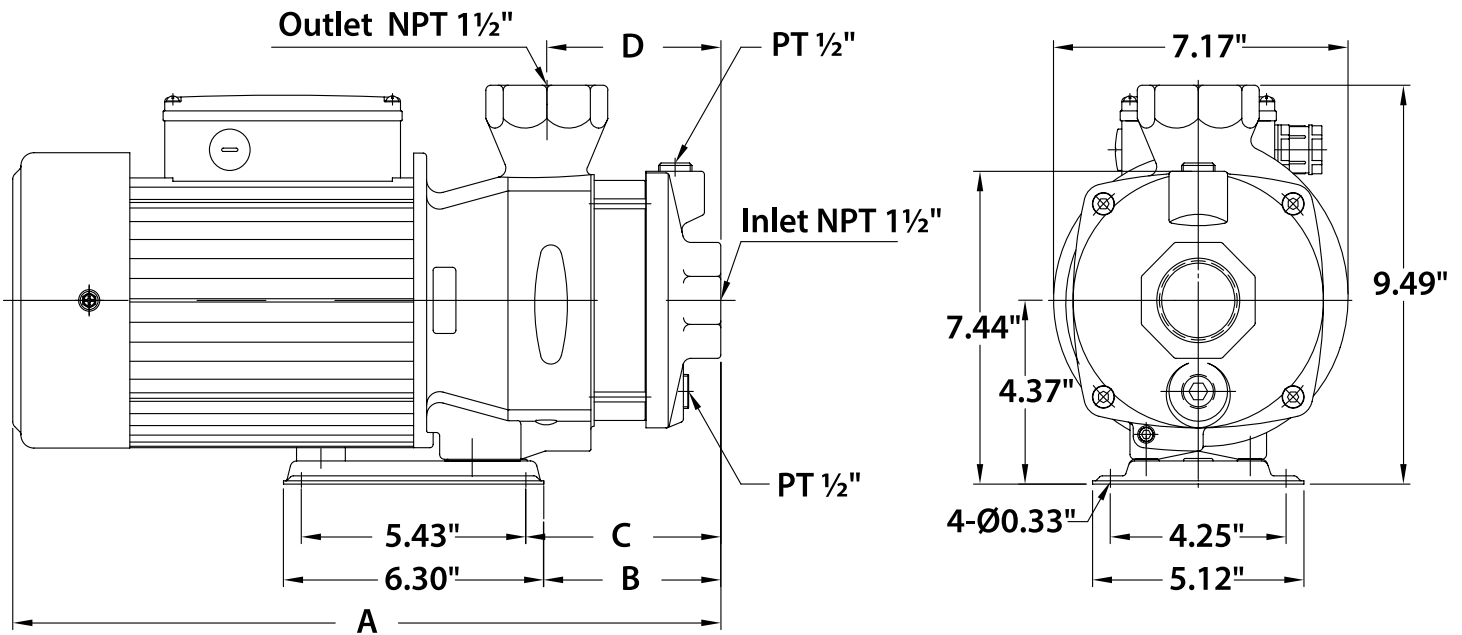

Model	A (inches)	B (inches)	C (inches)	D (inches)	Weight (pounds)
GTPH8T2K	13.19	3.03	3.46	2.95	41.7
GTPH8T3K	16.02	4.29	4.72	4.21	43.0
GTPH8T4K	17.13	4.29	4.72	4.21	48.5
GTPH8T5K	18.46	5.63	6.06	5.55	57.5